

PERMIT
CITY OF NAPOLEON, OHIO — DEPT. OF BUILDING & ZONING
255 W. Riverview Avenue, Napoleon, Ohio 43545 (419) 592-4010

Permit No. 0920 Date 07 December 1984
 Job Location 225 Sheffield Avenue Valuation \$ 8,000.00
 Owner Nancy Hesper Address 225 Sheffield Avenue
 Contractor Bruns Construction Telephone No. 592-0256
 Address Rte 5 Napoleon, Ohio 43545
 Electric Contractor Bostelman Electric 232 Rohrs 599-3416
 Plumbing Contractor _____
 Mechanical Contractor _____

This permit is issued for work described in the plans, specifications, and/or application submitted, as approved by the Building Commissioner of the City of Napoleon, Ohio. Work shall conform to all pertinent construction and land use Codes and Ordinances.

PAID

Work Information:

Residential R 4 Commercial _____ Industrial _____
No. dwelling units
 New Construction _____ Addition 32 x 26 Remodel _____
 Brief Description of Work Garage and room addition

DEC 7 1984

ISSUED BY Richard G. Heyman DEPT. OF BUILDING & ZONING
Building Official

PER

It is the owners or contractors responsibility to call the Building Department for the following (X) inspections:

- Footing excavation prior to placing concrete.
- Footing drains and foundation prior to backfill.
- Prepared sub-grade prior to placing concrete floor slab.
- Sanitary sewer
- Rough-in electrical, plumbing and service framing prior to installing wall board.
- Final electrical, plumbing and heating.
- Final building inspection, prior to occupancy.

PERMIT & FEES

Building Permit	\$ <u>21.00</u>
Electrical Permit	\$ <u>7.00</u>
Plumbing Permit	\$ _____
Mechanical Permit	\$ _____
Demolition Permit	\$ _____
Zoning Permit	\$ _____
Sign Permit	\$ _____
Water Tap	\$ _____
Sewer Tap	\$ _____
Temp. Elec.	\$ _____
Other _____	\$ _____
TOTAL FEES	\$ <u>28.00</u>
LESS FEES PAID	\$ <u>-0-</u>
BALANCE DUE	\$ <u>28.00</u>

Permit is not valid until all fees are paid in full, and shall be void if work is not started within six months of date above.

PERMIT

CITY OF NAPOLEON, OHIO — DEPT. OF BUILDING & ZONING
255 W. Riverview Avenue, Napoleon, Ohio 43545 (419) 592-4010

Permit No. 0720 Date 07 December 1984
Job Location 225 Sheffield Avenue Valuation \$ 1,000.00
Owner Nancy Beape Address 225 Sheffield Avenue
Contractor Brans Construction Telephone No. 592-0256
Address Ste 3 Napoleon, Ohio 43545
Electric Contractor Boatman Electric 232 Bohrs 599-2413
Plumbing Contractor _____
Mechanical Contractor _____

This permit is issued for work described in the plans, specifications, and/or application submitted, as approved by the Building Commissioner of the City of Napoleon, Ohio. Work shall conform to all pertinent construction and land use Codes and Ordinances.

DEC 7 1984

Work Information:

Residential 4 Commercial _____ Industrial _____
New Construction _____ Addition 32 x 26 Remodel _____
Brief Description of Work Garage and room addition

ISSUED BY Richard J. Hayman DEPT. OF BUILDING & ZONING
Building Official

It is the owners or contractors responsibility to call the Building Department for the following (X) inspections:

- Footing excavation prior to placing concrete.
- Footing drains and foundation prior to backfill.
- Prepared sub-grade prior to placing concrete floor slab.
- Sanitary sewer
- Rough-in electrical, plumbing and service framing prior to installing wall board.
- Final electrical, plumbing and heating.
- Final building inspection, prior to occupancy.

PERMIT & FEES

Building Permit	\$ <u>21.00</u>
Electrical Permit	\$ <u>7.00</u>
Plumbing Permit	\$ _____
Mechanical Permit	\$ _____
Demolition Permit	\$ _____
Zoning Permit	\$ _____
Sign Permit	\$ _____
Water Tap	\$ _____
Sewer Tap	\$ _____
Temp. Elec.	\$ _____
Other	\$ _____
TOTAL FEES	\$ <u>28.00</u>
LESS FEES PAID	\$ _____
BALANCE DUE	\$ <u>28.00</u>

Permit is not valid until all fees are paid in full, and shall be void if work is not started within six months of date above.

07 DEC 84 -- REQUIRED 1/2 HOUR FIRE RATING
 BETWEEN GARAGE & DWELLING.
getter send

INSPECTION RECORD

UNDERGROUND			ROUGH-IN &			FINAL		
Type	Date	By	Type	Date	By	Type	Date	By
PLUMBING								
Sewer Connection			Drainage, W. & Vent			Drainage, W. & Vent		
Building Sewer			Water Piping			Water Heater		
Water Piping			Condensate Lines			Backflow Prevention		
			Indirect Waste					
						FINAL APPROVAL		
ELECTRICAL								
Floor Ducts Raceways			Rough Wiring			Electric Mtr. Clearance		
Conduits & or Cable			Conduits/ Cable			Signs		
Grounding & or Bonding			Service Panel Switchboard					
			Subpanels					
			<input type="checkbox"/> Range <input type="checkbox"/> Dryer			FINAL APPROVAL		
MECHANICAL								
Refrigerant Piping			Refrigerant Piping			Duct Insulation		
Ducts/ Plenums			Ducts/ Plenums			Chimney(s)		
			Ventilation <input type="checkbox"/> Supply			Furnace(s)		
			<input type="checkbox"/> Exhst.			FINAL APPROVAL		
Location, Set-backs, Esmt(s)			Wall Construction	12/14/84	PEB	Fireplace Chimney		
Excavation			Crawl Space <input type="checkbox"/> Vent <input type="checkbox"/> Access			Attic <input type="checkbox"/> Vent <input type="checkbox"/> Access		
Footings & Reinforcing			Floor System(s)			Special Insp Reports Rec'd		
Sub-soil Drain			Roof System			Smoke Detector		
Foundation Walls			Fire Wall(s)			Demolition (sewer cap)		
Floor Slab			Roof Cover/ Roof Drain			Building or Structure		
FINAL APPROVAL BLDG. DEPT			Certificate of Occupancy Issued			#		3/15/85

CITY OF NAPOLEON
 BUILDING INSPECTION DEPARTMENT
 APPLICATION FOR BUILDING PERMIT
 (Please print or type)

The undersigned hereby makes application for construction, installation, or alteration work as herein specified, agreeing to do all such work in strict accordance with the City of Napoleon's adopted Building Codes.

Location of project 225 Sheffield Cost of project \$8000⁰⁰
 Owner's Name Nancy Heape Address 225 Sheffield
 Contractor Bruns Const. Telephone No. 592-0256
 Address P.O. Napoleon Ohio 43545

Lot Information: (Not required for siding job)

Lot No. _____ Subdivision _____
 Zoning District _____ Lot Size _____ ft. X _____ ft. Area _____ sq. ft.
 Setbacks: Front _____ Right Side _____ Left Side _____ Rear _____

Work Information:

Residential Commercial _____ Industrial _____
 New Construction _____ Addition Remodel _____
 Accessory Building _____ Siding alum -
 (Specific Type)

Brief Description of Work:-----

Garage + small room addition

Size: Length 32 Width 26 No. of Stories 1
 Area: 1st Floor 832 sq. ft. Basement _____ sq. ft.
 2nd Floor _____ sq. ft. Accessory Bldg. _____ sq. ft.
 3rd Floor _____ sq. ft. Other 125 sq. ft.

Additional Information: _____

APPLICATION FOR PERMIT, SHALL BE ACCOMPANIED BY TWO COMPLETE SETS OF PLANS INCLUDING: ELEVATIONS, FLOOR PLANS, CROSS SECTIONS AND PLOT PLAN. IF ADDITION OR REMODELING, SHOW ALL EXISTING STRUCTURES AND THEIR SIZE AND LOCATION. ALL PLANS SHALL BE DRAWN TO SCALE.

Date Oct 6 '89 Applicant's Signature Eldor Bruns

PERMIT NO. 9202
 PERMIT FEE \$ 21.00

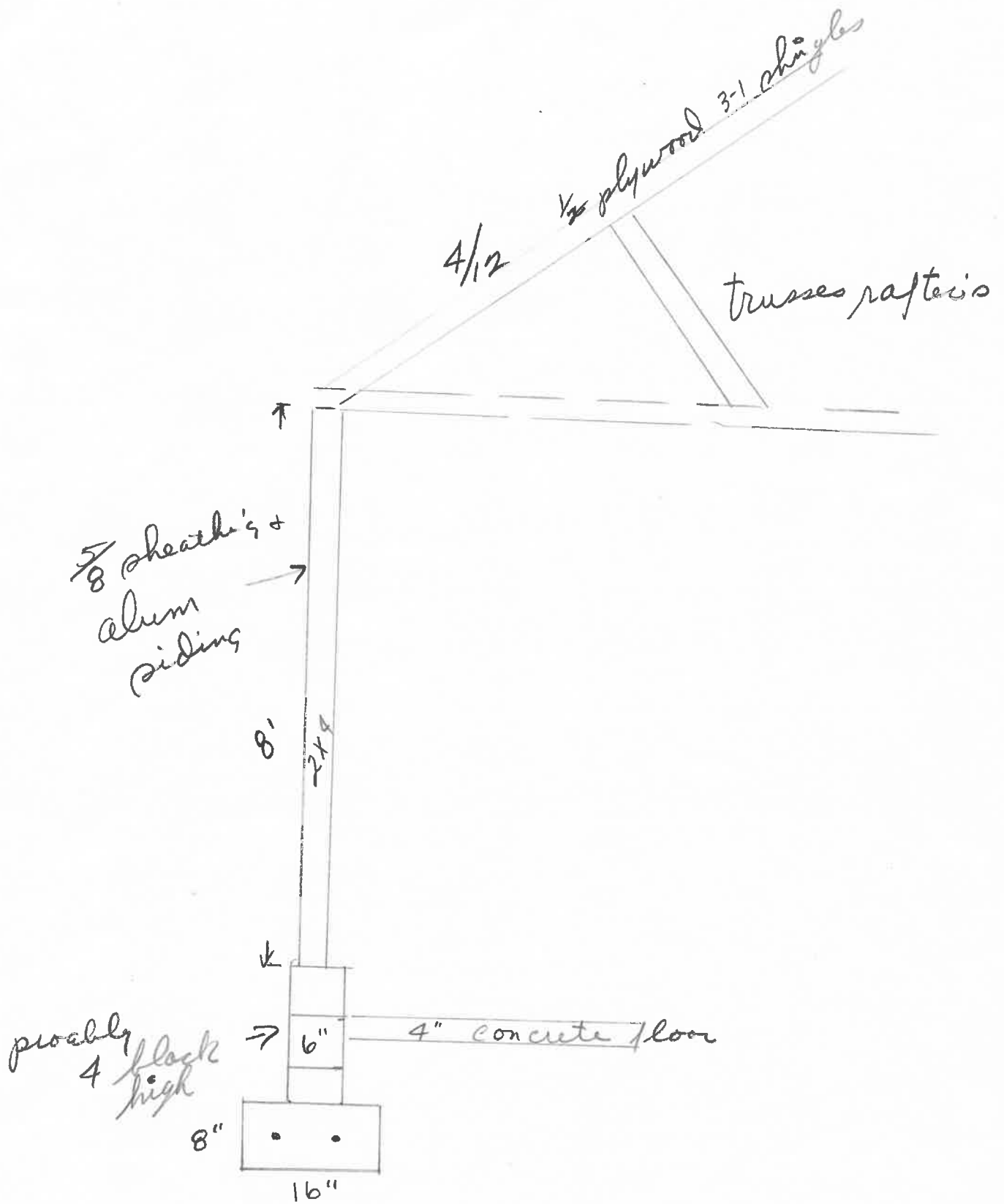

Wall section of garage

City of NAPOLEON, OHIO

255 RIVERVIEW AVENUE - (419) 592-4010
NAPOLEON, OHIO 43545-0151

07 December 1984



Bruns Construction
Route 5
Napoleon, Ohio 43545

Mayor
Robert G. Heft

RE: 225 Sheffield Avenue

Clerk-Treasurer
Rupert W. Schweinhagen

Dear Mr. Bruns:

Members of Council
Darel AusterMiller, President
William Young
Lawrence Haase
Darrell Fox
Donald Morford
Lynn Wachtmann

The following item is the current violation of the 1984 Ohio Basic Building Code on the above referenced project which must be brought into conformance before final approval is given by this department.

Sec. 613.1, OBBC, Dwellings. $\frac{1}{2}$ " Gypsum board or equivalent must be applied to the open studding on the garage side of the wall dividing the garage and the dwelling. This material must be applied all the way to the rafters to provide $\frac{1}{2}$ hour fire-rating separation between the garage and the dwelling and attic areas.

City Manager
Richard A. Hayward

The above item shall be required to be brought into conformance before final approval will be given.

Law Director
Keith P. Muehlfeld

Yours truly,

Paul E. Buehrer
Paul E. Buehrer
Engineering Technician

pc/Richard Hayman

